

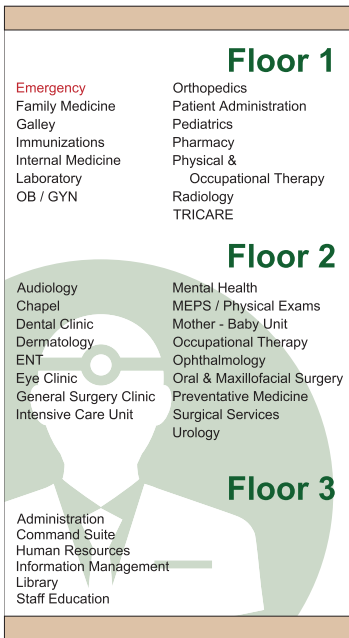

Sign Type: I
42.0"W x 8.0"H

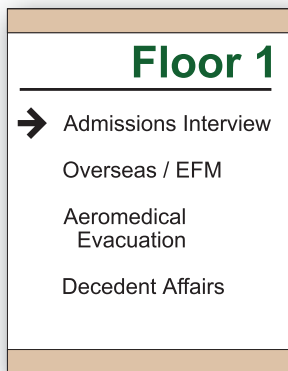

Sign Type: A 22"W x 40.0"H



Sign Type: B 18"W x 23.0"H

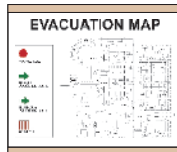

Sign Type: C
11"W x 9.5"H



Sign Type: D
5.5"W x 5.0"H



Sign Type: E
5.5"W x 3.0"H

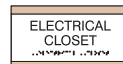

Sign Type: F
7.5"W x 4.0"H



Sign Type: G
6.5"W x 8.5"H

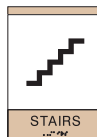

Sign Type: H
8.125"W x 7.5"H

Series SP 1100 features a direct pass through slot for graphic inserts from left or right, having the slimmest profile of the Clarke Systems family of modified, acrylic signage.

- Contrasting ADA compatible raised lettering and numbers
- Grade II Braille beads in standard clear, white, black, or stainless
- 25 standard colors available for body and copy
- 5 font styles
- Single window featured
- Other sizes and configurations available
- Standard office paper used for smaller signs
- Styles A, B & I require large-bed printer access with 48" paper
- 28#, 98% white paper recommended
- Simple graphic insertion & removal
- Double-sided projected or suspended styles available for overhead visibility



= Price Range Comparison

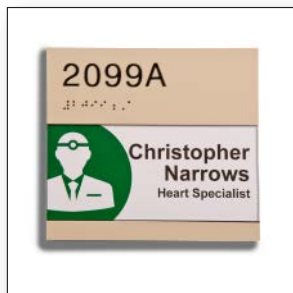

Actual Photograph of Sign Type: D