

Installation Instructions For Typical SLATZ®

WALL/DOOR SIGNS

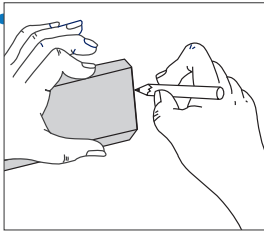

Hold plate on wall at desired location. Mark sides and corners.

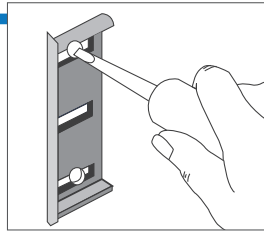

Remove end caps. Hold caps to corner markings and mark end cap mounting holes. Drill holes, insert anchors, and fasten caps to wall. do not fasten tightly; allow for minor adjustment.

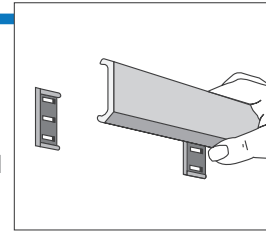

Snap faceplate into place.

SINGLE-COLUMN DIRECTORIES

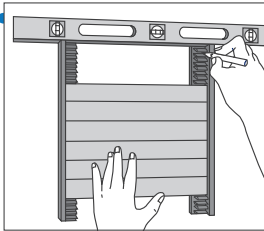

Remove plates, where shown, to expose mounting holes. For taller directories, check the tracks for additional holes. Position on mounting surface, level, and mark holes.

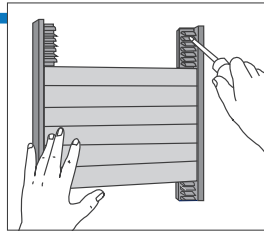

Drill holes in wall where indicated and insert anchors. Line directory up to holes and fasten with screws.

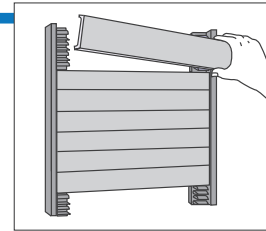

Replace plates.

MULTI-COLUMN DIRECTORIES

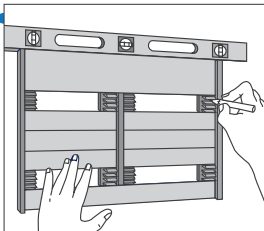

Remove plates, where shown, to expose mounting holes. Position on mounting surface, level, and mark holes.

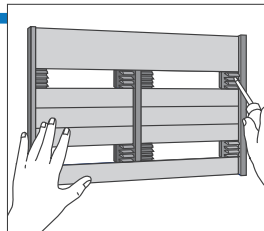

Drill holes in wall and insert anchors. Line directory up to holes and fasten with screws.

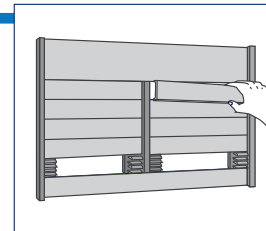

Snap faceplate into place.

FLUSH-MOUNT CEILING DIRECTORIES

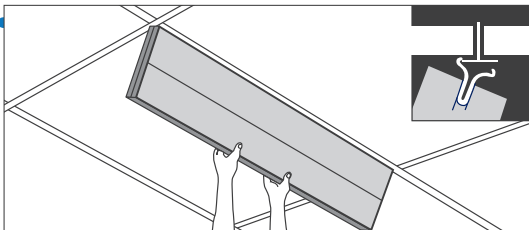

Hook one side of the ceiling clips to metal ceiling strip as shown in insert.

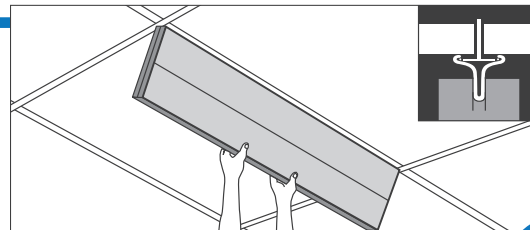

Finish by hooking the second side of clips as shown in inset.

CLARKE SYSTEMS

1857 Walnut Street, Allentown, PA 18104
Phone: 800-331-1891 | Fax: 610-434-9868

Architectural Sign Systems

www.clarkesystems.com

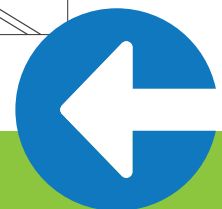

Find us on 